

Navigation Remote Controller (Wired Remote Controller)

BRC1E71

Simple operation. Large and clear display. Auto-changeover. Advanced scheduling. Independent setpoints control.

The Navigation Remote Controller is the latest addition to Daikin's controls suite which offers scalable control architecture optimized for VRV and SkyAir technology. The wall mounted controller features a backlit LCD display as well as intuitive menus. The menu displays are now available in English, French, or Spanish languages.



Basic Operation

- On/Off, Operation mode, Setpoint, Fan speed
- Airflow direction (Menu)

Function

- Setpoint range limit (Service menu)
- Individual button prohibit (Service menu)
- Independent occupied and unoccupied (setback) heating and cooling setpoints
- Auto-changeover with cooling and heating setpoints, for heat pump and heat recovery systems
- Schedule
 - Weekly schedule – 7 days (7), weekday plus weekend (5+2), or weekday plus Saturday plus Sunday (5+1+1) configurable
 - Five events per day – On (with individual cooling and heating setpoints), Off (with individual Setup/Setback setpoints)

Display

- Standard display mode
 - Operation mode, Occupied and unoccupied setpoint(s), Fan speed
- Detailed display mode
 - Operation mode, Occupied and unoccupied setpoint(s), Fan speed, Airflow direction, Room temperature, Day, Time
- Error code, System status (centralized control, master controlled)

Others

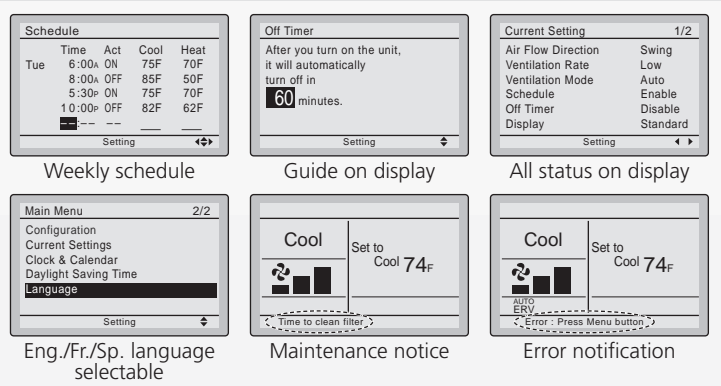

- Backlit
- Room temperature sensor
- 12/24 hour clock
- Fahrenheit/Celsius selectable
- English/French/Spanish (buttons and system status displays are in English only)
- Remote control group – up to 16 indoor units



For use with:
VRV III VRV-WIII VRV III-S SkyAir
 Backwards compatible with BRC1D71



Navigation Remote Controller

System Capabilities	Daikin VRV Controls		
			
	BRC1E71 Navigation Remote Controller	BRC2A71 Simplified Wired Remote	Wireless Remote Control (Model depends on unit)
Communications	2-Wire/DIII-Net	2-Wire/DIII-Net	Infrared
*F/°C Selector	■	*F only	*F only
Backlit LCD display	■		
Room temperature display	■		
Schedule and setback capabilities (with Time and Date display)	■		
User restriction options	■		
On/Off, Operation mode, Setpoint, Fan speed	■	■	■
Louver position adjustment	■		■
Reports system malfunctions	■	■	■
Space temperature sensor	■		
Simultaneous operation with Daikin multi-zone controllers		■	■
Simultaneous operation with BACnet® and LonWorks®		■	■
Group control capacity	Up to 16 indoor units	Up to 16 indoor units	Up to 16 indoor units



Independent occupied and unoccupied (Setback) heating and cooling setpoints

The Navigation Remote Controller features the introduction of occupied and unoccupied (setback) modes of operation. In the occupied mode, the unit is on and controls temperatures to setpoints.

In the unoccupied mode, the unit remains off and will energize once setback setpoints have been reached. It will de-energize once temperature has dropped (when cooling) or risen (when heating) by the set differential. The setback control can be disabled, and the unit stays off.

In the cooling, heating, and auto-changeover modes, temperatures are controlled by independent setpoints. In the cooling mode, only the cooling setpoints are valid and the heating setpoints are ignored and vice-versa. Both setpoints are valid in the auto mode.

Each setpoint can be bound by a range limit in order to maximize energy savings. The cooling and heating setpoint ranges can be set between 60°F (16°C) and 90°F (32°C) for occupied operation (unit on). The cooling setpoint range shall be equal or higher than the heating setpoint range. The cooling and heating setback setpoints can be set between 40°F (5°C) and 95°F (35°C), outside of the occupied setpoint ranges.

Schedule

A scheduling feature enhances flexibility by allowing three selectable weekly schedule pattern options: 7-Day, 5 + 2 (Weekday + Weekend), and 5 + 1 + 1 (Weekday + Saturday + Sunday). The schedule supports up to 5 On/Off operations per day and has the ability to set new individual occupied or setback cooling and/or heating setpoints per operation.

Auto-changeover

The Navigation Remote Controller features the introduction of auto-changeover for 2-pipe heat pump as well as 3-pipe heat recovery systems. Auto-changeover mode allows the optimal room temperature to be maintained without the user having to change the mode. It automatically switches the indoor unit's mode (heat or cool) according to both the room temperature and temperature setpoints.

- When in the heating mode, changeover to cooling mode shall occur at cooling setpoint +1°F (0.5°C).
- When in the cooling mode, changeover to heating mode shall occur at heating setpoint -1°F (0.5°C).

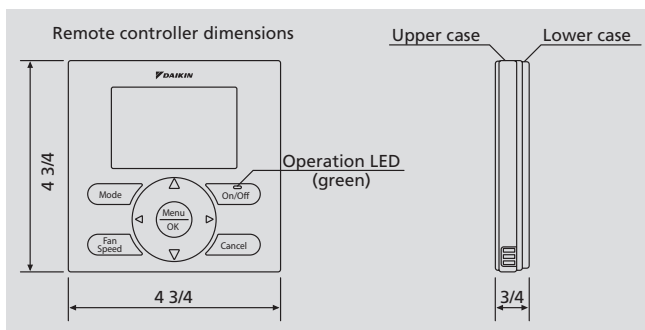

Form: FBRC1E71USE10-04C

Daikin's products are subject to continuous improvements. Daikin reserves the right to modify product design, specifications and information in this brochure without notice and without incurring any obligations.

CONTROL
www.daikinac.com